

**STRAIGHT PLUG RECEPTACLE FOR PCB**

**PRESS-FIT LEGS - COND 100**

**R214.416.700**

Series : SMZ (BT43)

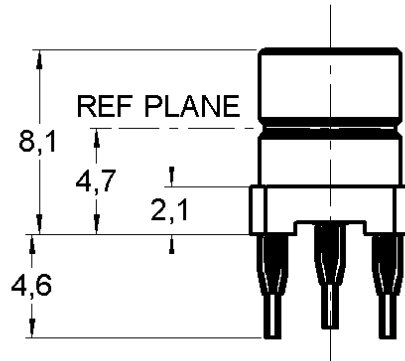
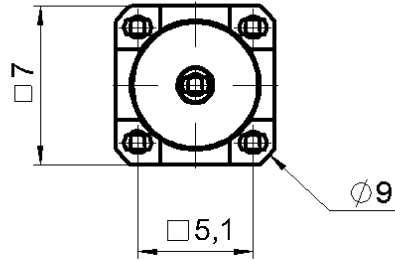

**PANEL CUT OUT**

	mm	
	Maxi	mini
A	2.565	2.515
B	1.09	0.94
C	5.105	5.055

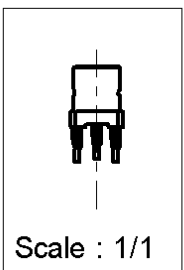

All dimensions are in mm.

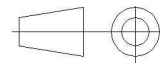
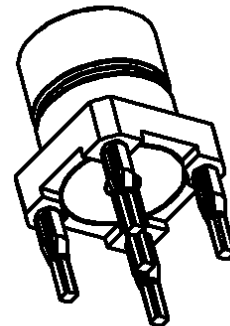

COMPONENTS	MATERIALS	PLATING (µm)
BODY	BRASS	GOLD 0.2 OVER NICKEL 2
CENTER CONTACT	BRASS	GOLD 1.3 OVER NICKEL 2
OUTER CONTACT	-	-
INSULATOR	PTFE	-
GASKET	-	-
OTHERS PARTS	Cu Sn 8 Hardness 160<HV<190	TIN 3 OVER NICKEL 2
-	-	-
-	-	-

Issue : 0540 B

In the effort to improve our products, we reserve the right to make changes judged to be necessary.



**STRAIGHT PLUG RECEPTACLE FOR PCB**

**R214.416.700**

**PRESS-FIT LEGS - COND 100**

Series : SMZ (BT43)

**PACKAGING**

**SPECIFICATION**

Standard	Unit	Other
<b>100</b>	<b>'W' option</b>	<b>Contact us</b>

**ELECTRICAL CHARACTERISTICS**

**ENVIRONMENTAL**

Impedance		<b>75</b> Ω
Frequency		<b>0-2.4</b> GHz
VSWR	<b>NA +</b>	<b>0.000</b> x F(GHz) Maxi
Insertion loss		<b>NA</b> √F(GHz) dB Maxi
RF leakage	<b>- (</b>	<b>60</b> - F(GHz)) dB Maxi
Voltage rating		<b>500</b> Veff Maxi
Dielectric withstanding voltage		<b>1500</b> Veff mini
Insulation resistance		<b>1000</b> MΩ mini

Operating temperature	<b>-40/+100</b> ° C
Hermetic seal	<b>NA</b> Atm.cm3/s
Panel leakage	<b>NA</b>

**OTHER CHARACTERISTICS**

Assembly instruction **NA**

Others :  
Type SMZ

**MECHANICAL CHARACTERISTICS**

Center contact retention		
Axial force – Mating end	<b>22</b>	N mini
Axial force – Opposite end	<b>22</b>	N mini
Torque	<b>NA</b>	N.cm mini
Recommended torque		
Mating	<b>NA</b>	N.cm
Panel nut	<b>NA</b>	N.cm
Mating life	<b>250</b>	Cycles mini
Weight	<b>1.100</b>	g

Issue : 0540 B

In the effort to improve our products, we reserve the right to make changes judged to be necessary.



**STRAIGHT PLUG RECEPTACLE FOR PCB**

**R214.416.700**

**PRESS-FIT LEGS - COND 100**

Series : SMZ (BT43)

**MOUNTING**

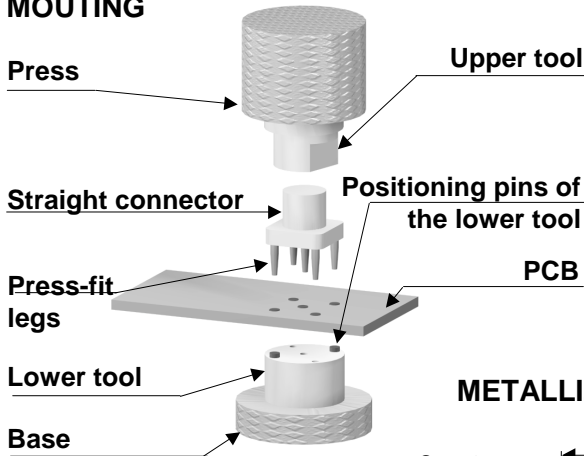

**UNMOUNTING**

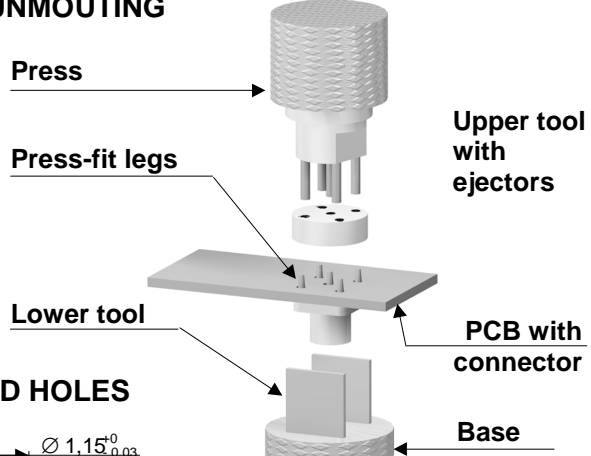

**METALLIZED HOLES**

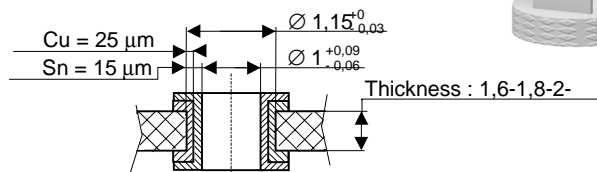

**1**

Slide the upper tool into the machine (press).  
Slide the lower tool ( R282.878.523) into the base.

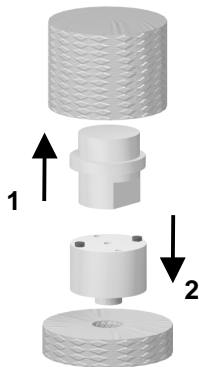

**1**

Place correctly the PCB and the connector on the lower tool.( R282.878.533)

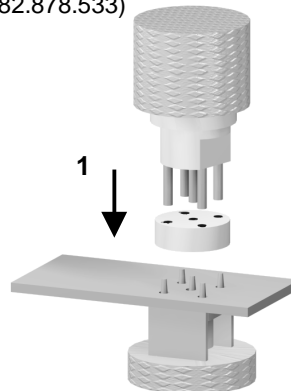

**2**

Place correctly the PCB on the lower tool.  
Introduce the press-fit legs into the holes of the PCB.  
Push on top (100N mini per press-fit leg) until total insertion.  
Note: the connector body must rest on the PCB.

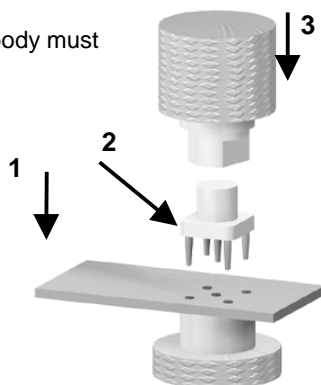

**2**

Place the upper tool ( R282.878.513) at the back of the connector and place correctly the ejectors :  
- on the press-fit legs (if their length exceed the PCB thickness)  
- in the holes of the PCB (if not).  
Press the upper tool (100N mini per press-fit leg) to remove the connector until it slide down into the lower tool.

**CAUTION :**  
A plated hole of the PCB can be used up to 3 times.

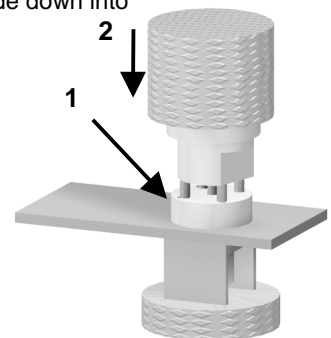

Issue : 0540 B

In the effort to improve our products, we reserve the right to make changes judged to be necessary.

